



A large Nabataean-Roman period house at adh-Dharih

Zeidoun Al-Muheisen, Pauline Piraud-Fournet

► To cite this version:

Zeidoun Al-Muheisen, Pauline Piraud-Fournet. A large Nabataean-Roman period house at adh-Dharih. *Studies in the history and archaeology of Jordan*, 2013, XI, pp.833-846. halshs-00861999

HAL Id: halshs-00861999

<https://shs.hal.science/halshs-00861999>

Submitted on 15 Sep 2013

HAL is a multi-disciplinary open access archive for the deposit and dissemination of scientific research documents, whether they are published or not. The documents may come from teaching and research institutions in France or abroad, or from public or private research centers.

L'archive ouverte pluridisciplinaire **HAL**, est destinée au dépôt et à la diffusion de documents scientifiques de niveau recherche, publiés ou non, émanant des établissements d'enseignement et de recherche français ou étrangers, des laboratoires publics ou privés.

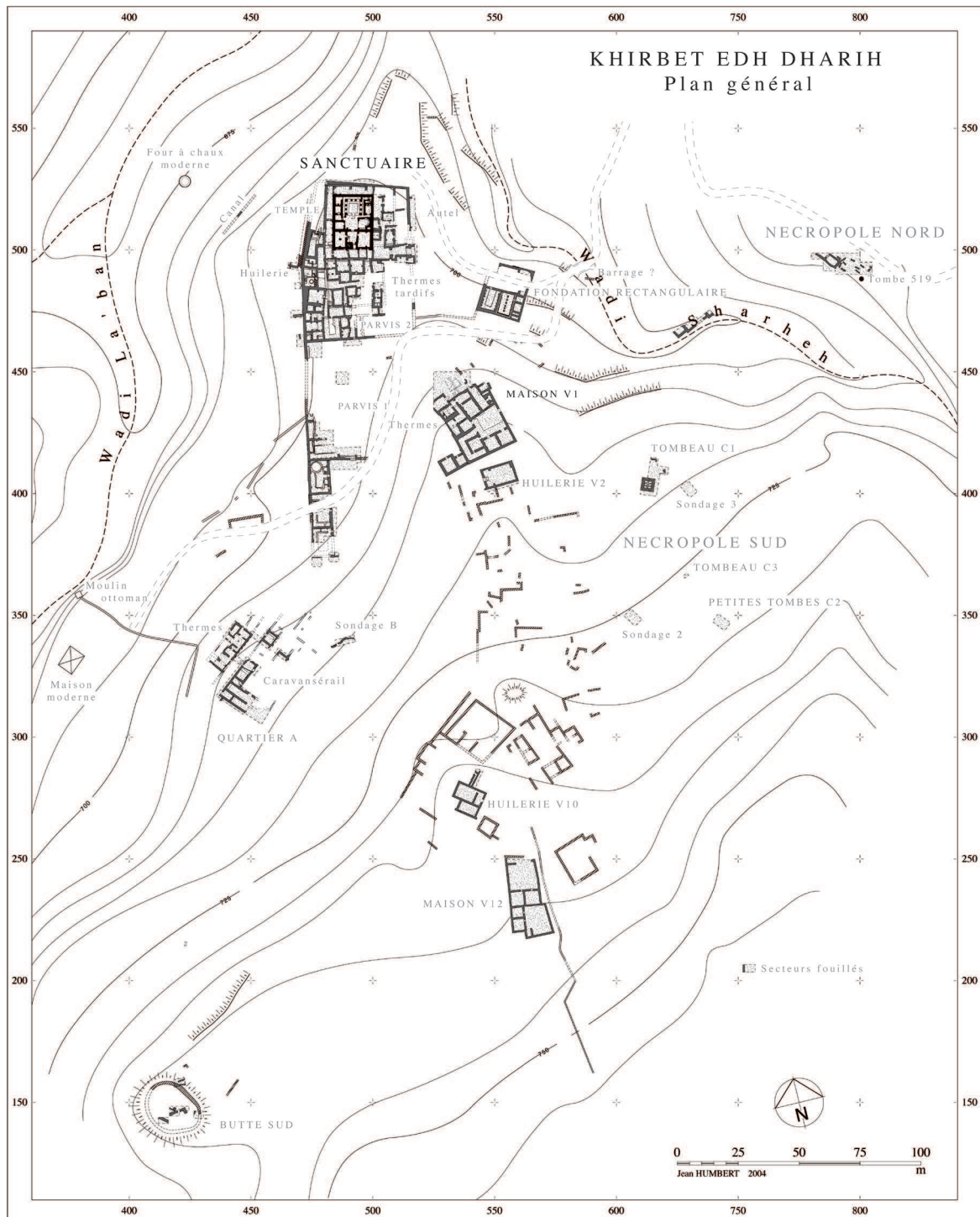


Fig. 1. Plan of the site of Dharih (By J. Humbert 2004)



Fig. 2. House V1, the sanctuary and the hills of the Wadi al-Hasa, looking north
(photo P. P.-F. 2010)

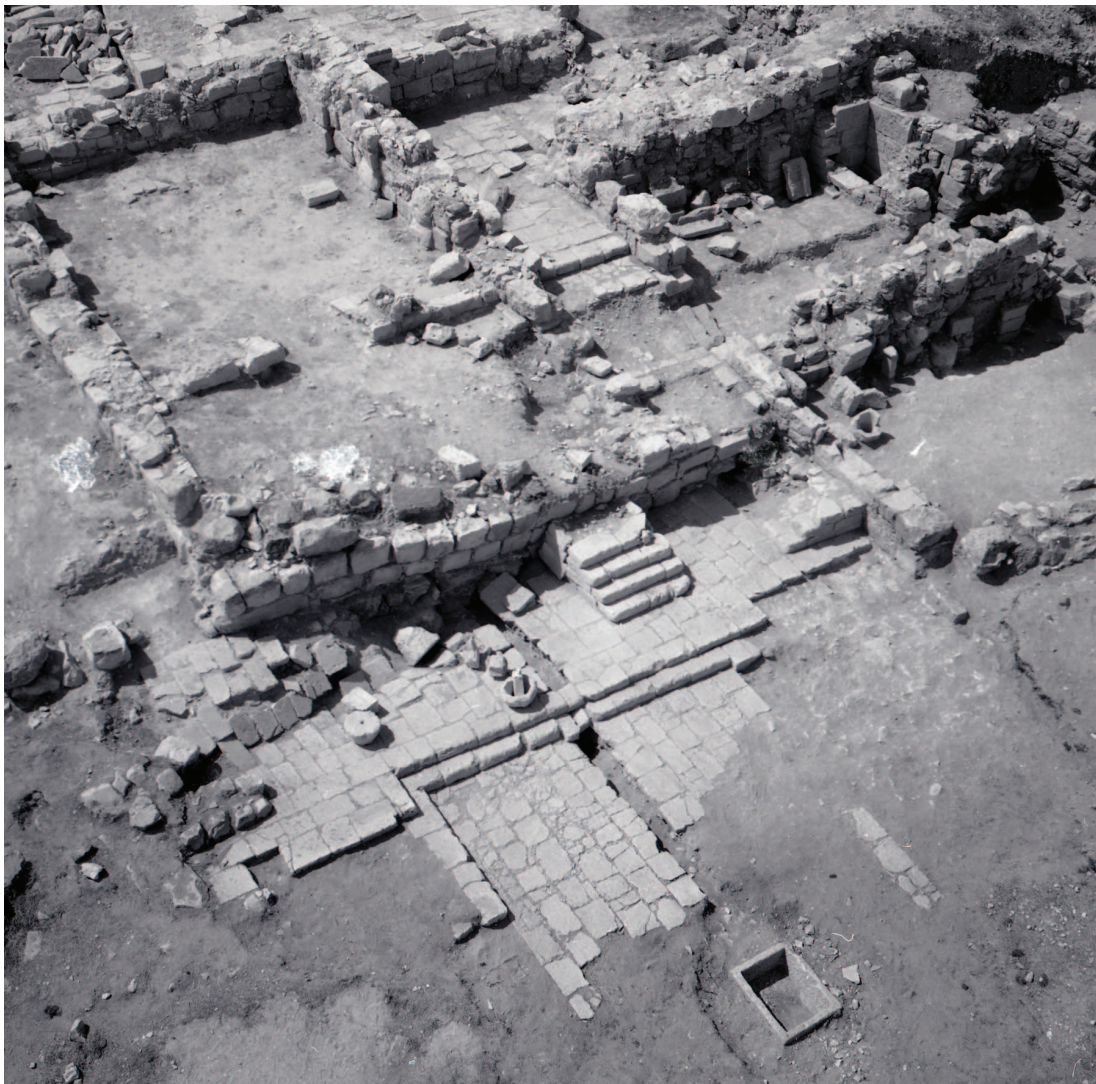


Fig. 4. Aerial view of the house, looking south. Esplanade (S) in the foreground
(photo H. Fontaine 1996)

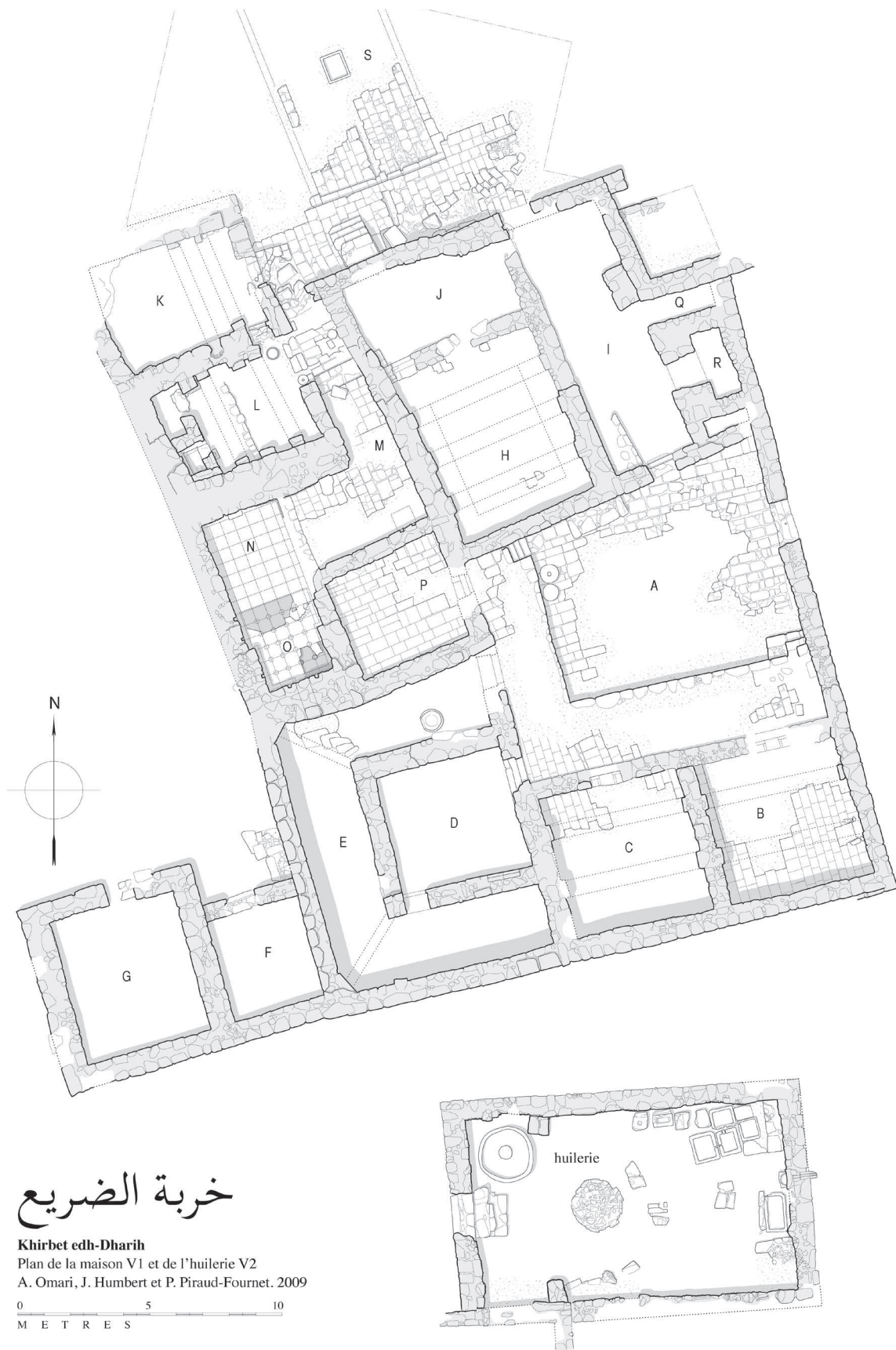


Fig. 3. Plan of house V1 (by A. Omari and P. P.-F. 1996–2007)



Fig. 5. Aerial view of the house, looking south



Fig. 6. Façade of room (J) and the upper part of the esplanade (S) deformed by and earthquake (photo P. P.-F. 2007)



Fig. 7. Corridor (M) and the square notches in the southern wall at the back
(photo P. P.-F. 2007)



Fig. 8. The heated chamber (N-O) looking south, the hypocausts and chimneys for the smoke
(photo F. Villeneuve 1993)



Fig. 9a and b. Capital (a) and base (b)
of a column (photo P. P.-F. 2010)

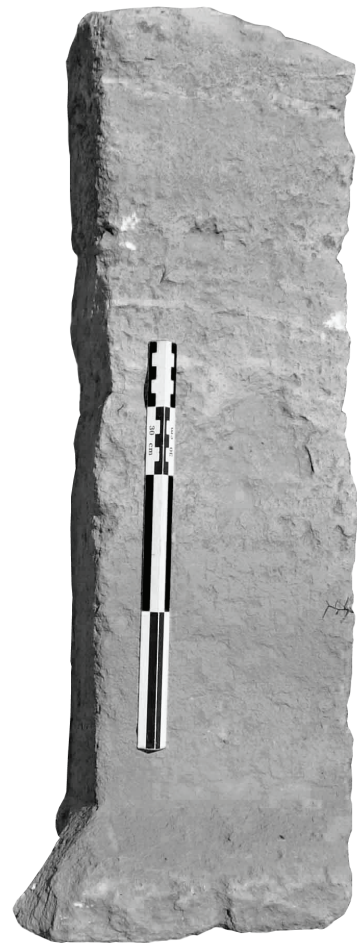
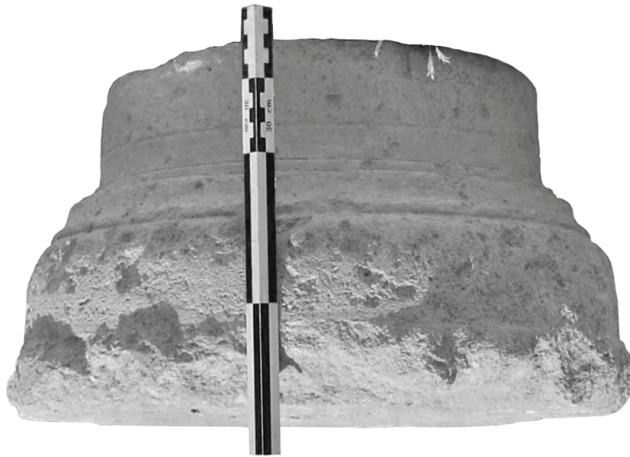


Fig. 12a and b. The long betyl 13.001 from room (K) (photo P. P.-F. 2007)
and the short betyl 8.242 from the esplanade (photo Y. Zu'bi)



Fig. 10. Rooms (D) and (E), probably a stable.
Remains of mangers both fallen and in situ (photo P. P.-F. 2010)

Fig. 11. Oblique reconstruction of the stable in house V1 (by P. P.-F. 2010)

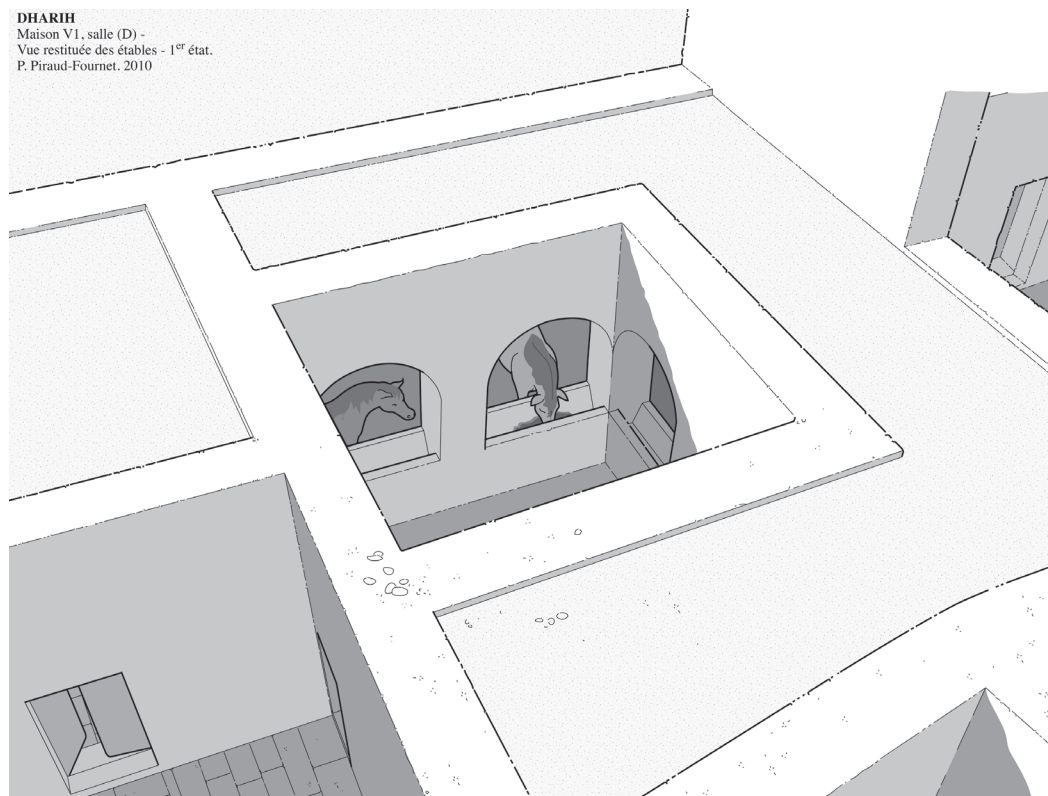




Fig. 13. The niche with round basin in room (L) (photo Y. Zu'bi 1993)

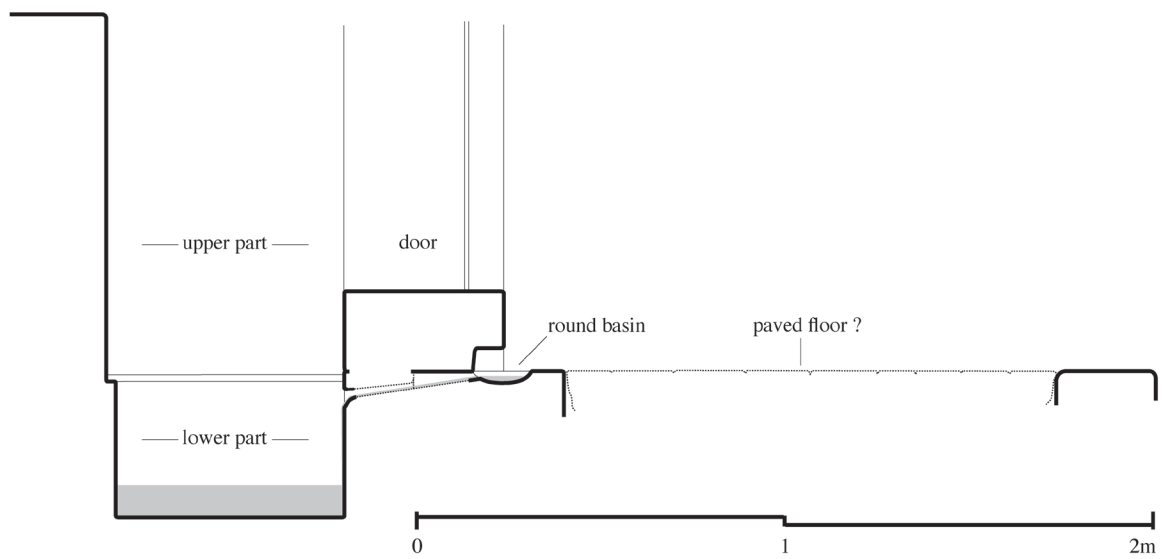


Fig. 14. Section through the niche with round basin in room (L) (by P. P.-F. 2010)

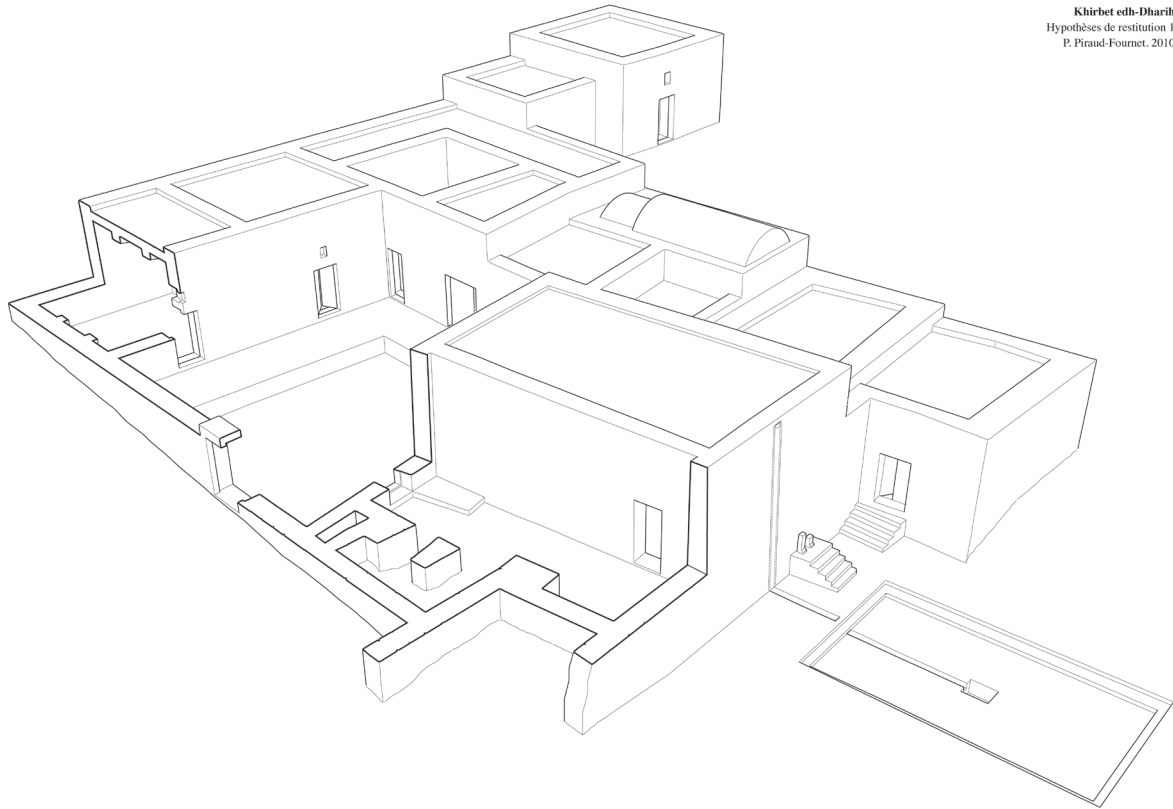


Fig. 15. A first hypothetical reconstruction of the house, looking southwest
(by P. P.-F. 2010)

Fig. 16. Façade of the “Garden triclinium” in Petra, from the outside (photo P. P.-F. 2010)

Fig. 17. Façade of the “Garden triclinium” in Petra, from the inside (photo P. P.-F. 2010)



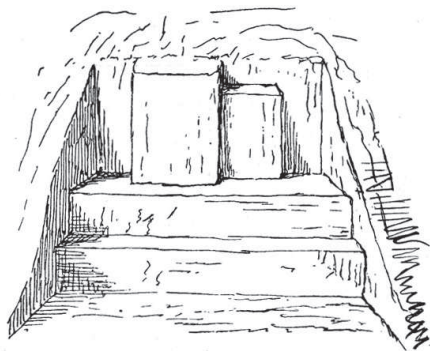


Abb. 43: Idolnische Nr. 75.

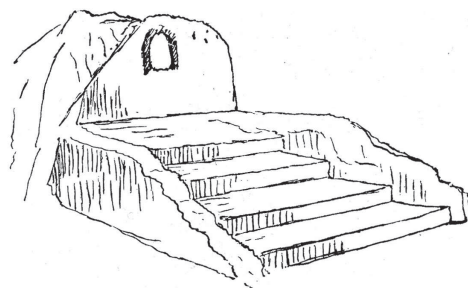


Abb. 135: Idolnische Nr. 286 mit Treppe.

Fig. 18a and b. Petra, a) Niche for betyl, b) niche with steps
(by Dalman 1908, figs 43 and 135)

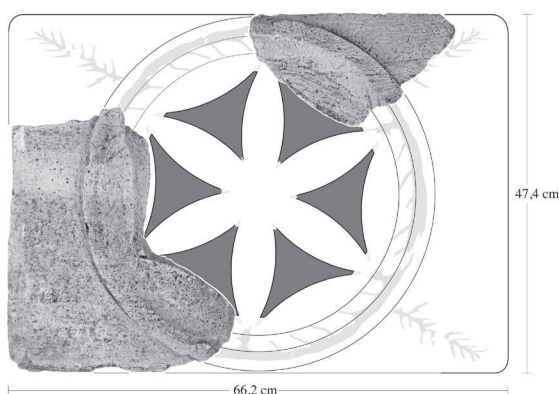
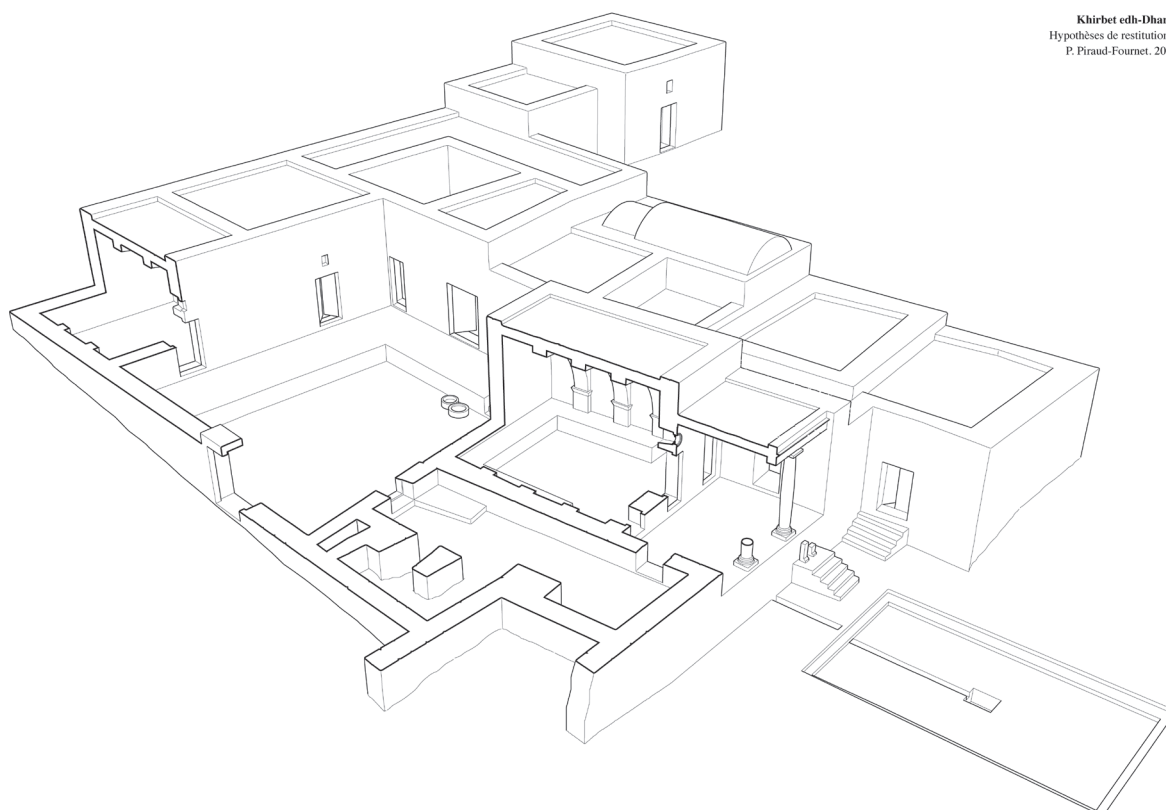


Fig. 20. Limestone window
with latticework,
(photo D. Seigneuret 2007
and reconstruction by P. P.-F. 2010)



Khirbet edh-Dharib
Hypothèses de restitution 2
P. Piraud-Fourmet. 2010

Fig. 19. A second hypothetical reconstruction of the house, looking southwest
(by P. P.-F. 2010)

